

CLAM PASS PARK BOARDWALK REPAIR CONSTRUCTION PLANS

INDEX

1. COVER SHEET
2. BOARDWALK PLAN VIEW
3. BOARDWALK TYPICAL SECTIONS
4. BOARDWALK IMPROVEMENT LISTS

GENERAL NOTES

1. INFORMATION SHOWN HEREON REFLECTS CONDITIONS AS THEY EXISTED ON THE SURVEY DATE SHOWN AND CAN ONLY BE CONSIDERED INDICATIVE OF CONDITIONS AT THAT TIME.
2. AERIAL PHOTOGRAPH PROVIDED BY COLLIER COUNTY, DATED DECEMBER 2013.
3. ELEVATIONS SHOWN ARE BASED ON THE NORTH AMERICAN VERTICAL DATUM (NAVD88).
4. INSPECTION WAS CONDUCTED BY COASTAL ENGINEERING CONSULTANTS, INC. BETWEEN APRIL 3 & APRIL 15, 2015.

DIRECTIONS TO SITE

FROM US 41 HEAD WEST ON SEAGATE DRIVE. END AT CLAM PASS PARK, 465 SEAGATE DRIVE.

PUBLISHED TIDAL INFORMATION

TIDAL DATUMS IN NAPLES, GULF OF MEXICO

ARE BASED ON FLORIDA 872 5110

TIDE STATION, PUBLISHED 4-21-2003

LENGTH OF SERIES

TIME PERIOD = 1/1983-12/1986 ; 1/1989-12/2001

TIDAL EPOCH = 1983-2001

CONTROL TIDE STATION = NAPLES - GULF OF MEXICO (872 5110)

ELEVATIONS OF TIDAL DATUMS ARE REFERENCED IN

NAVD 1988.

MEAN HIGH WATER (MHW) = +0.33 FT NAVD

MEAN LOW WATER (MLW) = -1.68 FT NAVD

MEAN LOWER LOW WATER (MLLW) = -2.28 FT NAVD

DATUM

0.0 NAVD (1988) = +1.28 NGVD (1929)

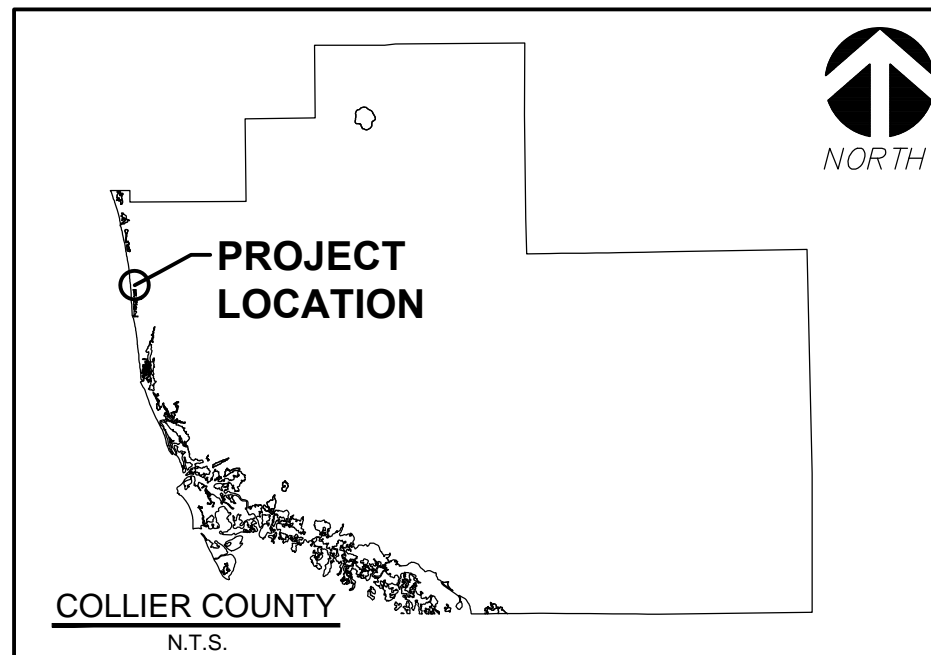

LOCATION MAP

SCALE: 1" = 1500'

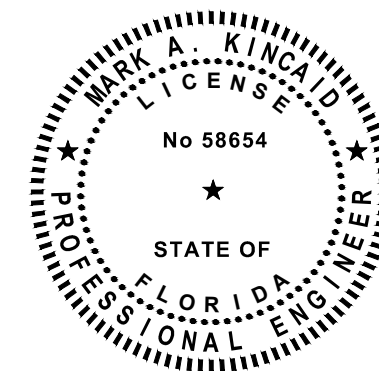
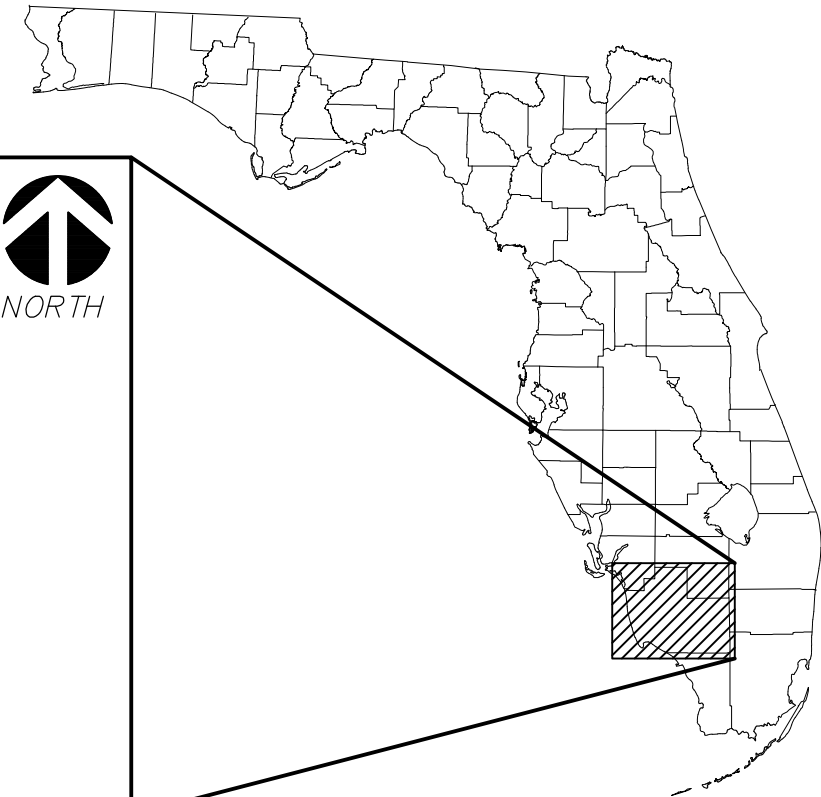

DATE:	6/29/15	SCALE:	AS NOTED
DRAWN:	GYT	BY:	
CHECKED:	MTP	PG.	
SEC.	TYP.	RNG.	
ACAD NO.	14184-Clm Pass-C.dwg	REF. NO.	14.184
NO.		DATE	
BY			
REVISION DESCRIPTION			
COLLIER COUNTY			
COVER SHEET			
CIVIL ENGINEERING SURVEY & MAPPING COASTAL ENGINEERING ENVIRONMENTAL PLANNING SERVICES PHONE: (239)643-2324 FAX: (239)643-1143 www.coastalengineering.com E-Mail: info@cecifl.com			
COASTAL ENGINEERING CONSULTANTS INC. A CECI GROUP COMPANY Serving Florida Since 1977 3106 SOUTH HORSESHOE DRIVE NAPLES, FLORIDA 34104			
SHEET 1			
FILE NO.: 14184-C-1			

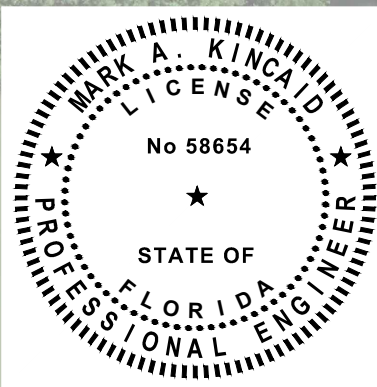
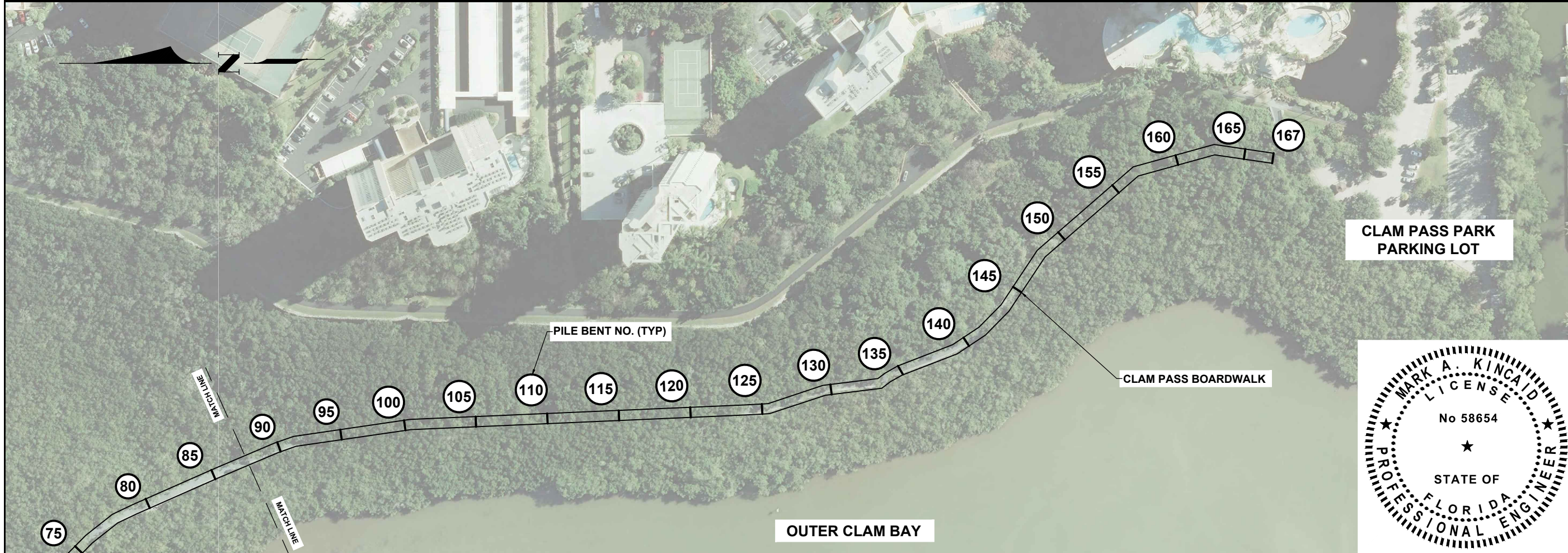
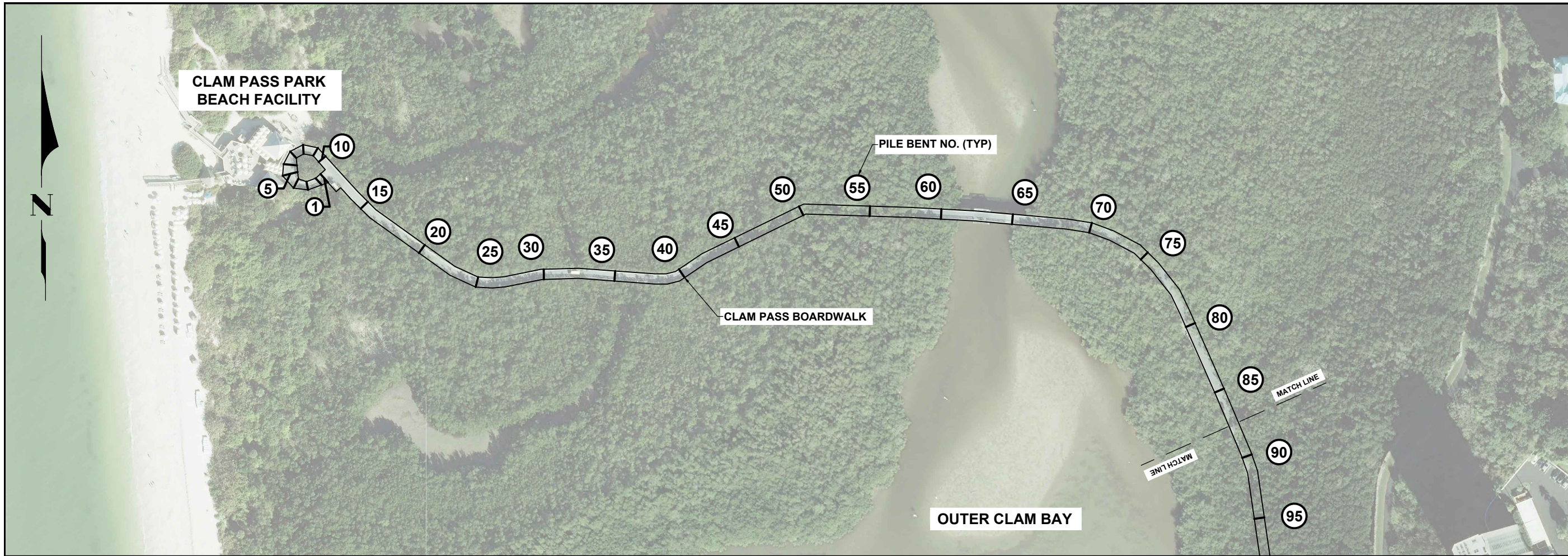

DATE: 6/29/15		SCALE: 1" = 150'
DRAWN: GYT	CHECKED: MTP	DATE: 14.184
SEC: TYP	ACAD NO: 14184-Clm Pass-C.dwg	NO. 14.184
CLIENT: COLLIER COUNTY		BY:
TITLE: BOARDWALK PLAN VIEW		DATE:
CIVIL ENGINEERING		REVISION DESCRIPTION:
SURVEY & MAPPING		
COASTAL ENGINEERING		
ENVIRONMENTAL		
PLANNING SERVICES		
PHONE: (239)643-2324		
FAX: (239)643-1143		
www.coastalengineering.com		
E-Mail: info@cecill.com		
COASTAL ENGINEERING CONSULTANTS		
A CECI GROUP COMPANY		
Serving Florida Since 1977		
3106 SOUTH HORSESHOE DRIVE		
NAPLES, FLORIDA 34104		
SHEET 2		
FILE NO: 14184-C-2		

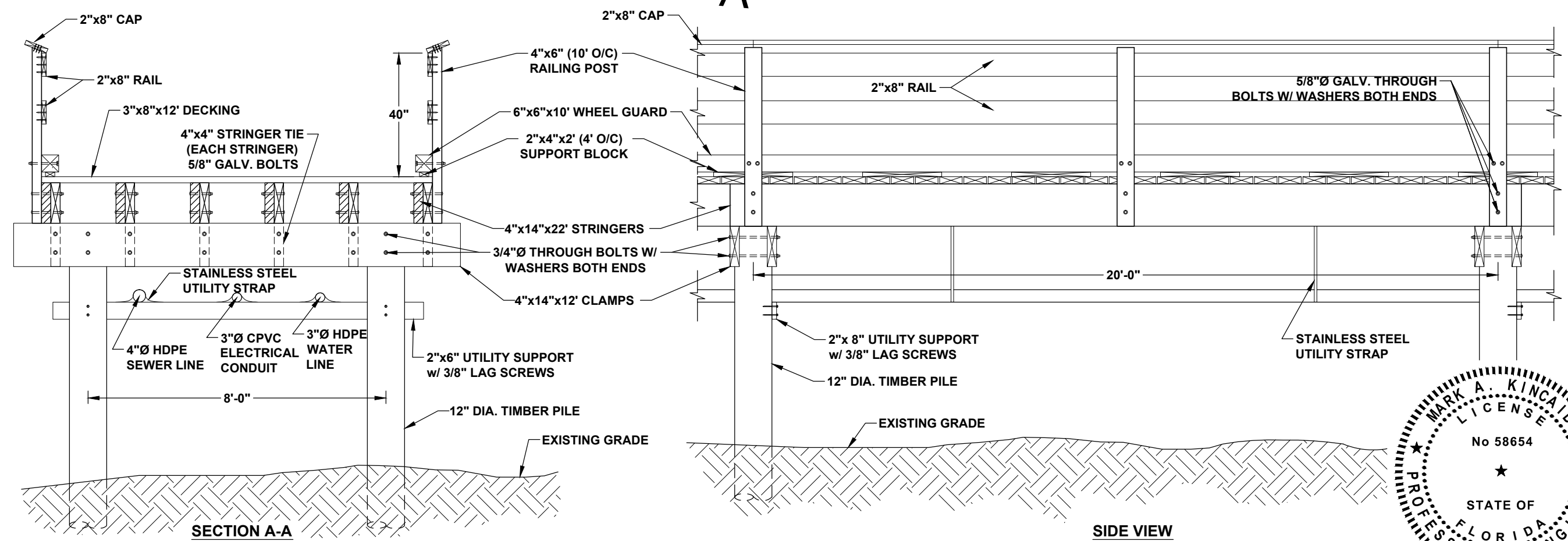
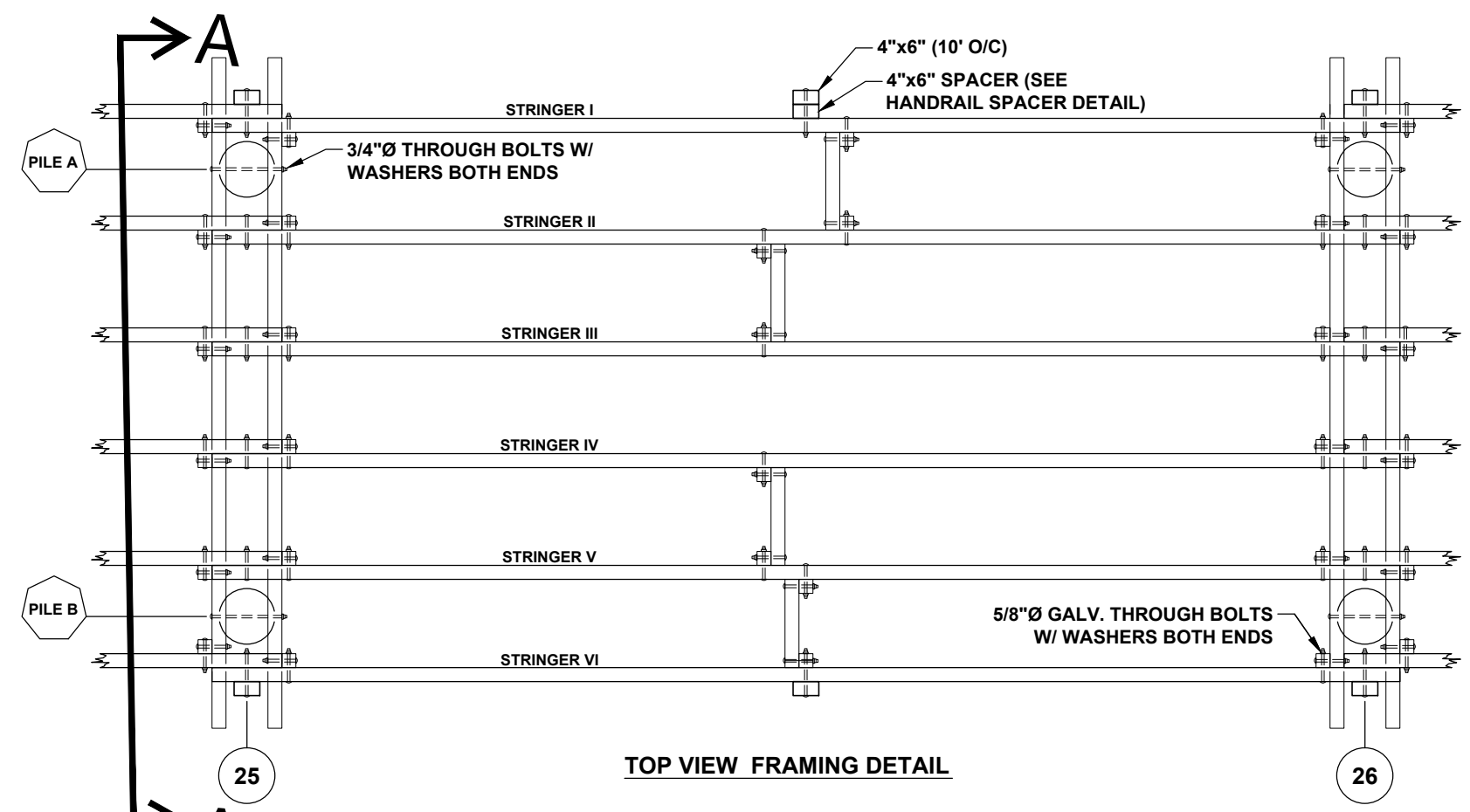
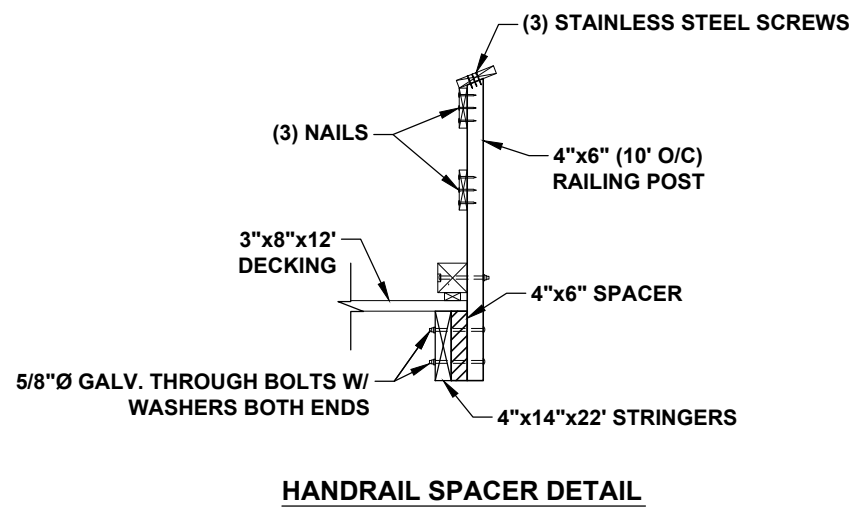

SCALE: 1" = 3'

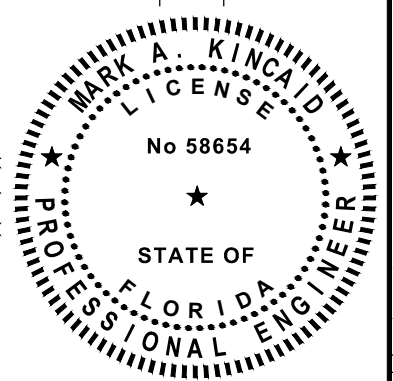

DATE: 6/29/15		SCALE: AS NOTED	
DRAWN: GVT	DATE: 6/29/15	DATE: 6/29/15	SCALE: AS NOTED
CHECKED: MTP	DATE: 6/29/15	DATE: 6/29/15	SCALE: AS NOTED
SEC. TYP. RING.	DATE: 6/29/15	DATE: 6/29/15	SCALE: AS NOTED
ACAD NO. 14184-Clm Pass-C.dwg	DATE: 6/29/15	DATE: 6/29/15	SCALE: AS NOTED
REF. NO.	DATE: 6/29/15	DATE: 6/29/15	SCALE: AS NOTED
NO. 14.184	DATE: 6/29/15	DATE: 6/29/15	SCALE: AS NOTED
BY	DATE: 6/29/15	DATE: 6/29/15	SCALE: AS NOTED
CLIENT: COLLIER COUNTY			
TITLE: BOARDWALK TYPICAL SECTIONS			
CIVIL ENGINEERING			
SURVEY & MAPPING			
COASTAL ENGINEERING			
ENVIRONMENTAL			
PLANNING SERVICES			
PHONE: (239)643-2324			
FAX: (239)643-1143			
www.coastalengineering.com			
E-Mail: info@cecfil.com			
COASTAL ENGINEERING CONSULTANTS			
INC.			
A CECI GROUP COMPANY			
Serving Florida Since 1977			
3106 SOUTH HORSESHOE DRIVE			
NAPLES, FLORIDA 34104			
SHEET 3			
FILE NO.: 14184-C-3			

PILES - REPLACE	
BENT	PILE
2	A
3	A
11	A
14	B
17	B
18	A
22	B
23	B
24	B
26	B
37	A
41	B
42	A
42	B
43	A
43	B
44	B
46	A
51	B
60	A
60	B
72	B
73	B
74	B
97	A

STRINGERS - REPLACE	
SPAN	STRINGER NUMBER
19/20	IV
21/22	II, IV, V
22/23	II, III
24/25	IV
25/26	IV, V
36/37	II
41/42	II
42/43	II
44/45	II
46/47	III
47/48	V
48/49	II, VI
49/50	VI
74/75	V
97/98	IV
101/102	III
106/107	IV
107/108	IV
109/110	II
111/112	IV
112/113	IV
116/117	VI
121/122	IV
142/143	V
149/150	IV
150/151	II, III
153/154	V
163/164	IV
165/166	IV
166/167	V, VI

PILES - WRAP	
BENT	PILE
32	A
32	B
33	A
33	B
60	A
60	B
68	A
68	B

UTILITY SUPPORTS - REPLACE	
BENT	
17	
20	
29	
42	
72	
99	

HARDWARE - REPLACE	
SECTION (SPANS)	PERCENTAGE
1 - 27	50
28 - 31	30
44 - 57	30
58 - 61	25
68 - 71	25
72 - 142	33
143 - 167	10

HAND RAILS & POSTS - REPAIR/REPLACE		
BENT/PILE/SPAN	ELEMENT	REPAIR/REPLACE
14/15	HAND RAIL LOOSE	REPAIR
18A	RAILING POST	REPLACE
40/41	BOTTOM RAIL LOOSE	REPAIR
45B	RAILING POST	REPLACE
152/153	HAND RAIL DISPLACED	REPLACE
155/156	BOTOM AND TOP RAIL	REPLACE
164/165	HAND RAIL DISPLACED	REPLACE

STRINGER TIES - REPLACE	
BENT	NUMBER OF TIES
14	1
18	3
24	1
30	2
45	1
48	1
51	2
53	1
143	1

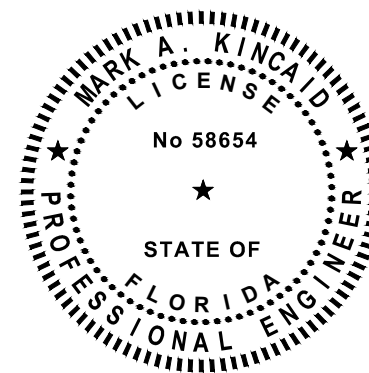

CLIENT: COLLIER COUNTY TITLE: BOARDWALK IMPROVEMENT LISTS		DATE: 6/29/15 DRAWN: GYT CHECKED: MTP SEC: TYP ACAD NO: 14184-Clm Pass-C.dwg REF. NO: 14.184	SCALE: N.T.S. DATE: BY: NO:
CIVIL ENGINEERING SURVEY & MAPPING COASTAL ENGINEERING ENVIRONMENTAL PLANNING SERVICES PHONE: (239)643-2324 FAX: (239)643-1143 www.coastalengineering.com E-Mail: info@ceefil.com		COASTAL ENGINEERING CONSULTANTS INC. A CECI GROUP COMPANY Serving Florida Since 1977 3106 SOUTH HORSESHOE DRIVE NAPLES, FLORIDA 34104	
SHEET 4		FILE NO: 14184-C-4	